



M

M E Y E R

M A N S I O N

美 雅 豪 苑

THE SEASIDE ADDRESS
FOR THE DISCERNING

FREEHOLD

传承稀世名宅 · 坐拥海岸之心

美雅豪苑 永久地契



ARTIST'S IMPRESSION 艺术效果图

BE AWED BY

UNRIVALLED PANORAMIC VIEWS

全景视野 旷世绝伦

With the shimmering waters of the East Coast on one side and the landed enclave stretching to Paya Lebar on the other, Meyer Road is one of the most prestigious addresses in Singapore. Well-known for sprawling mansions and exclusive apartments, it's rare to find a new development along this esteemed stretch. Perhaps even rarer, would be to find an iconic freehold development like Meyer Mansion in the near future. Bold yet understatedly modern, a distinctive façade of dark brown steel and burnished copper gold screens sets Meyer Mansion apart from its surrounding.

麦雅路是新加坡最负盛名的地段之一，与东海岸唯美天光水色毗邻，与大片延伸至巴耶利峇的大规模独栋洋房相接。这里以错落有致的豪宅与高档精致的公寓著称，新开盘的项目非常少。或许未来像美雅豪苑这种永久地契的豪宅项目会更罕见。宅邸正面是深棕色的钢筋质感，设有铮亮的铜金色屏风，大胆前卫又不失低调内敛，使美雅豪苑在一众风景中一枝独秀。

ARRIVE HOME
AND LEAVE THE WORLD BEHIND

远离尘嚣 返宅归家

The perfect 'welcome home' begins at the entrance.
Meyer Road is famed for the holiday mansions owned by affluent businessmen in the past.
These former bungalows were set back from the road with a driveway
lined with tropical trees leading to the front porch.
Enjoy the same privacy and privilege the moment you come home to Meyer Mansion.

踏进豪苑即是投入家的怀抱。过去富商们在此打造的度假豪宅如今让
麦雅路声名鹊起。这些早期的花园洋房并非位于主街附近，而是经由绿树掩映的私人车道连至家门口，
有赖于这一贴心设计，您在返回美雅豪苑这个温馨家园时能够尽享私密与尊贵。



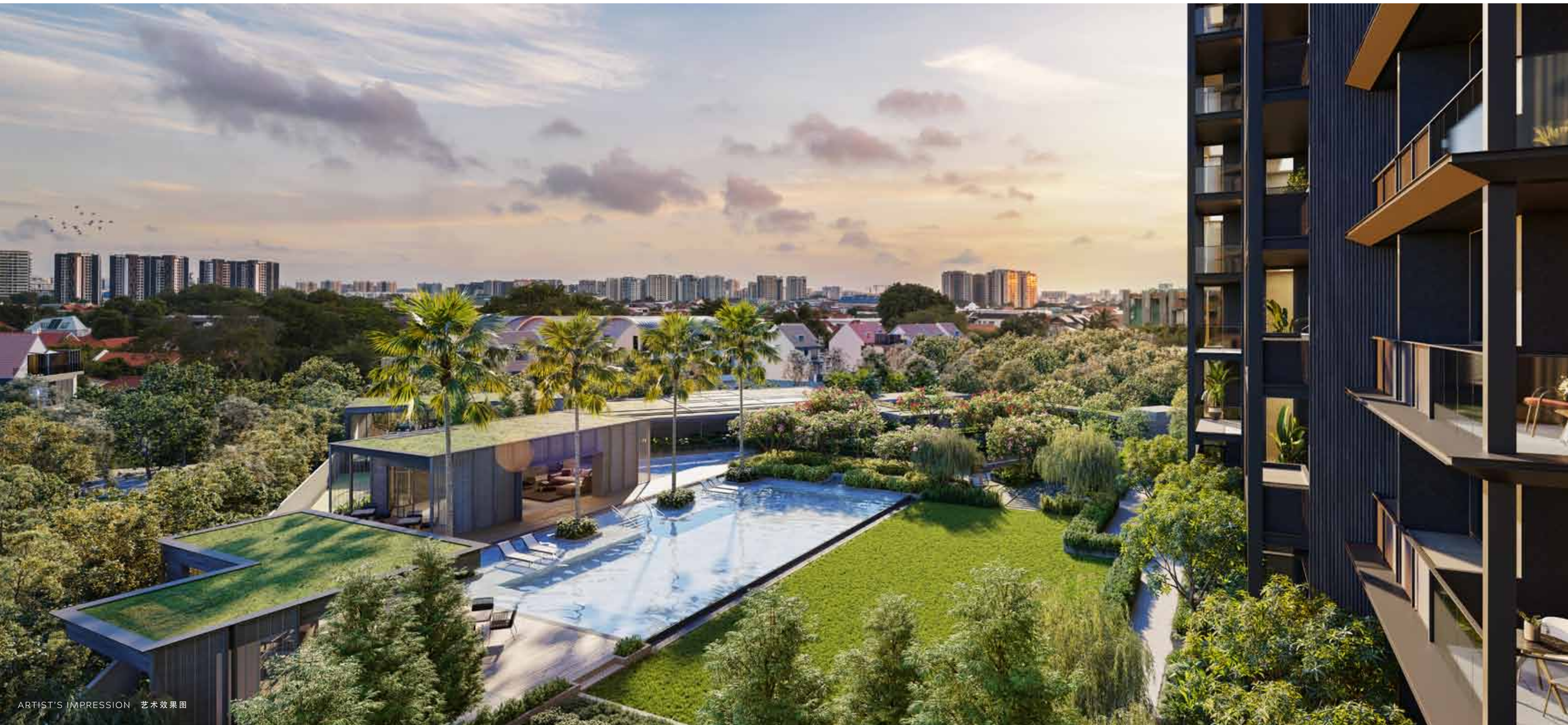

ARTIST'S IMPRESSION 艺术效果图

Inspired by seafront mansions in the past, 80% of Meyer Mansion has been dedicated to lush landscaping and amenities – a signature of GuocoLand's high-end residential developments. The ultimate in luxury is expressed through the generously sized Grand Lawn, 40-metre Swimming Pool, Clubhouse and Beach House. Take your pick of spaces and ambience to simply relax or entertain family and friends.

受以往海景别墅的启发，美雅豪苑80%的面积均用于打造丰富的园林生态和休闲设施——国浩集团高端住宅楼盘的一大特色。面积广阔的大草坪、40米泳池、私人会所和海滨别墅彰显极致奢华格调。无论是悠度闲暇时光还是款待亲朋好友，您都可恣意挑选心仪的居住空间与居住环境来满足不同需求。

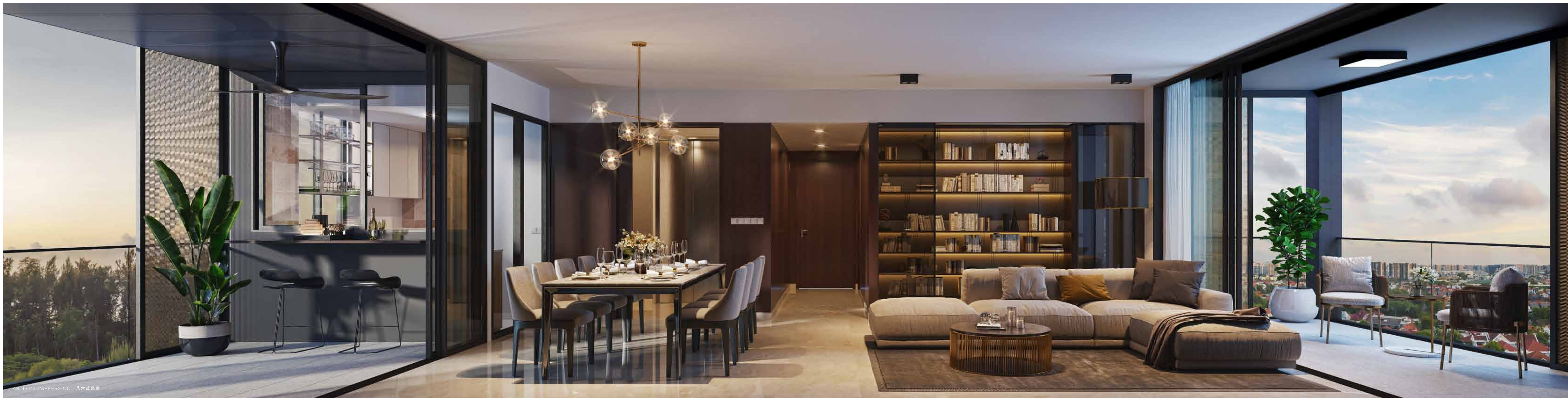

ARTIST'S IMPRESSION 艺术效果图

The layout for every mansion in the sky is inspired by old bungalows where space was the true luxury. Placing careful thought to your needs, all units are designed to be efficient and functional, giving you the flexibility to convert a bedroom into a family room, entertainment room or simply expand the living and dining areas. Floor to ceiling windows maximise the panorama of the sea and surrounding landed enclave, giving you unblocked views right in your home.

美雅豪苑的每栋豪宅均以旧式洋房的布局为借鉴，极为讲究空间利用。所有单位在充分考虑您需求的前提下致力实现高效实用的居住体验。生活空间也变得更加灵动：例如轻松把卧室变成家庭娱乐室或者单纯拓宽客厅和餐厅的空间等等。从地板到天窗的垂直高度足以将周边海景与地貌尽收眼底，让居家的您也能领略一望无际的自然风光。



M
MEYER
MANSION
美雅豪苑

CENTRAL BUSINESS DISTRICT
中央商务区

MARINA BAY SANDS
新加坡滨海湾金沙酒店

GARDENS BY THE BAY
滨海湾花园

MARINA BAY GOLF COURSE
新加坡滨海湾高尔夫球场

SINGAPORE FLYER
新加坡摩天观景轮

ORCHARD ROAD
乌节路

SINGAPORE INDOOR STADIUM
新加坡室内体育馆

SINGAPORE SPORTS HUB
新加坡体育城

KATONG PARK MRT STATION (U/C)*
加东公园地铁站 (在建中)*

EAST COAST PARK
东海岸公园

LANDED ENCLAVE
大规模独栋洋房

TANJONG KATONG MRT STATION (U/C)*
丹戎加东地铁站 (在建中)*

PARKLAND GREEN
东海岸公园饮食零售区

PARKWAY PARADE
百汇广场

*EXACT LOCATIONS FOR FUTURE AMENITIES TO BE DETERMINED BY AUTHORITIES *在建设地的确切位置未定, 以官方发布为准。

THE PRIVILEGE OF BEING
PERFECTLY POSITIONED

理想地段 传承价值

LOCATED AT THE
FRINGE OF THE CITY

都市繁华 近在咫尺



M
MEYER
MANSION
美雅豪苑

Strategically located to give you quick and easy connections to major expressways like the ECP and MCE, means you are in the city or the airport within minutes. With the upcoming Katong Park MRT Station just a 6-minute walk away, Meyer Mansion will be 6 stops from Raffles Place MRT Station once the Thomson-East Coast MRT Line is completed. The infinite value of convenience and time-savings can only be commanded by an address in a prime location.

美雅豪苑位于黄金地段，可快速方便地前往东海岸公园大道和滨海快速公路等主要高速公路，畅通无阻的交通意味着您能在短短数分钟内抵达市区或机场。从美雅豪苑步行至在建的加东公园地铁站仅需6分钟，汤申-东海岸地铁线开通后，业主只要乘坐6站地铁即可来到莱佛士坊地铁站。入住便捷省时的首善之地，传承无可限量的价值优势。

ARTIST'S IMPRESSION 艺术效果图

M MEYER MANSION 美雅豪苑

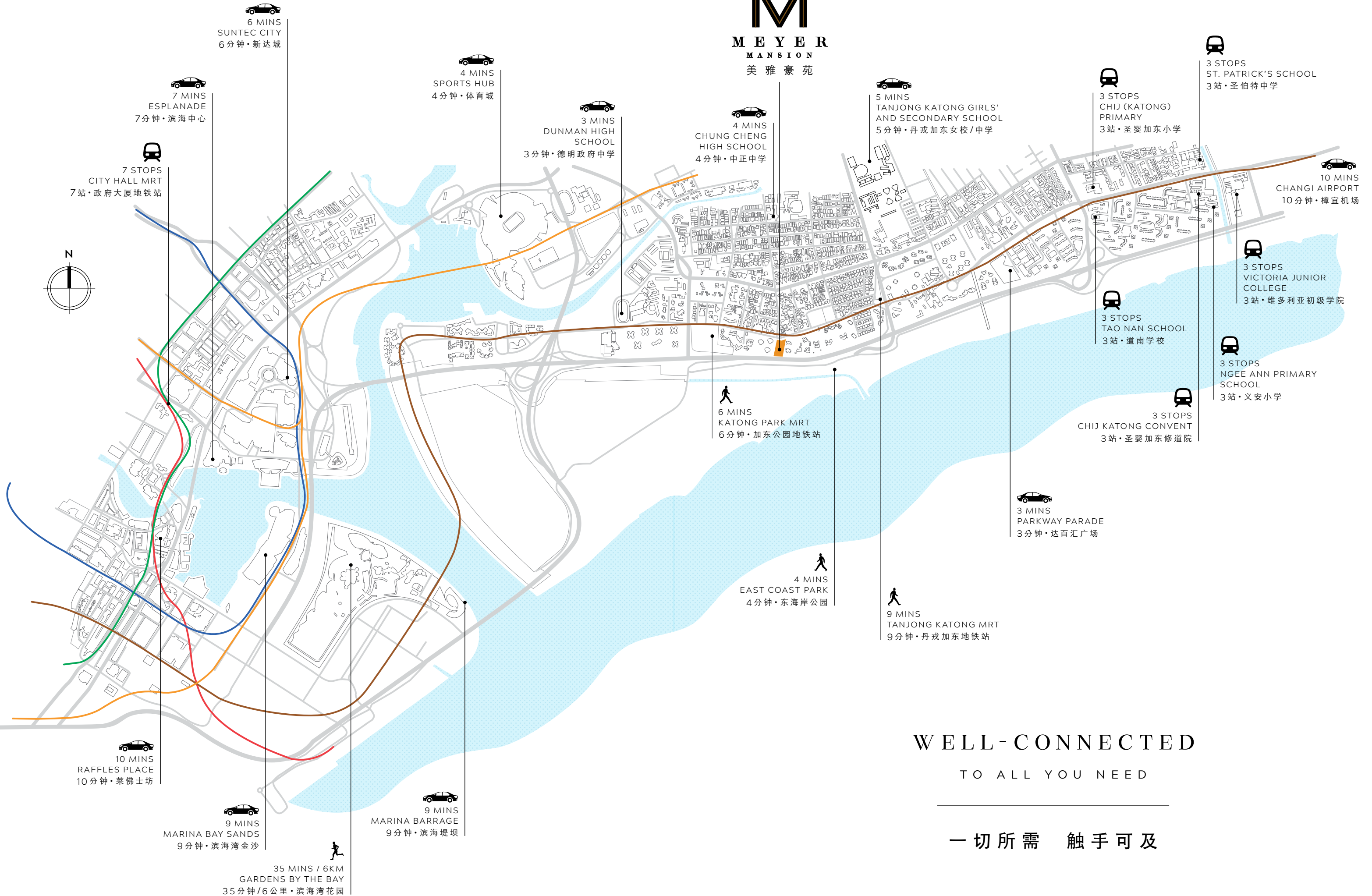

WELL-CONNECTED
TO ALL YOU NEED

一切所需 触手可及



TO EAST COAST PARK
前往东海岸公园

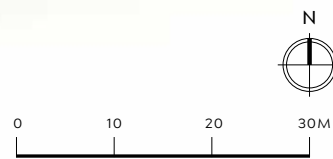

SITE PLAN

小区平面图

BASEMENT 地下室

- 1. ENTRANCE BOULEVARD
入口大道
- 2. PEDESTRIAN ACCESS
行人通道
- 3. RECEPTION LOUNGE
礼宾大堂

1ST STOREY 一层

- 4. ARRIVAL COURT
迎宾阁
- 5. GYM
健身房
- 6. CHANGING ROOM
更衣室
- 7. CHILDREN'S PLAYGROUND
儿童游乐场
- 8. WATER COURTYARD
水院
- 9. CHILDREN'S POOL
儿童泳池
- 10. CLUBHOUSE
会所
- 11. ALFRESCO DINING
露天用餐区
- 12. LOUNGE DECK
躺椅甲板
- 13. LEISURE POOL
嬉水池
- 14. JACUZZI
水疗按摩池
- 15. BBQ PAVILION
烧烤亭
- 16. OUTDOOR DINING
户外用餐区
- 17. SWING GARDEN
秋千花园
- 18. GARDEN PODS
花园座椅

- 19. MIST GARDEN
雾园

- 20. GRAND LAWN
庭院
- 21. COASTAL WALK
滨海小径
- 22. COASTAL COURTYARD
滨海庭院
- 23. COASTAL DECK
滨海水岸
- 24. PALM DECK
棕榈水岸
- 25. 40M LAP POOL
40米泳池
- 26. BEACH HOUSE
海滨别墅
- 27. BEACH ALFRESCO
海滩露天区
- 28. COCONUT GROVE
椰树林
- 29. SIDE GATE
侧门

OTHERS: 其他:

BASEMENT 地下室

- A. BIN CENTRE
垃圾收集站
- B. GENSET
发电机组
- C. SUBSTATION
配电室
- D. GUARD HOUSE
保安室

ROOF 天台

- E. WATER TANK
水箱



ARTIST'S IMPRESSION 艺术效果图

YOUR
FREEHOLD HOME

永久地契 豪华尊邸

公寓单元 UNIT	1	2	3	4	5	6	7	8
FLOOR 楼层								
25	A1-R	C2-R	C4-R (PL)	C3-R (PL)	B1-R	C1-R	D2-R (PL)	D1-R (PL)
24	A1	C2	C4 (PL)	C3 (PL)	B1	C1	D2 (PL)	D1 (PL)
23	A1	C2	C4 (PL)	C3 (PL)	B1	C1	D2 (PL)	D1 (PL)
22	A1	C2	C4 (PL)	C3 (PL)	B1	C1	D2 (PL)	D1 (PL)
21	A1	C2	C4 (PL)	C3 (PL)	B1	C1	D2 (PL)	D1 (PL)
20	A1	C2	C4 (PL)	C3 (PL)	B1	C1	D2 (PL)	D1 (PL)
19	A1	C2	C4 (PL)	C3 (PL)	B1	C1	D2 (PL)	D1 (PL)
18	A1	C2	C4 (PL)	C3 (PL)	B1	C1	D2 (PL)	D1 (PL)
17	A1	C2	C4 (PL)	C3 (PL)	B1	C1	D2 (PL)	D1 (PL)
16	A1	C2	C4 (PL)	C3 (PL)	B1	C1	D2 (PL)	D1 (PL)
15	A1	C2	C4 (PL)	C3 (PL)	B1	C1	D2 (PL)	D1 (PL)
14	A1	C2	C4 (PL)	C3 (PL)	B1	C1	D2 (PL)	D1 (PL)
13	A1	C2	C4 (PL)	C3 (PL)	B1	C1	D2 (PL)	D1 (PL)
12	A1	C2	C4 (PL)	C3 (PL)	B1	C1	D2 (PL)	D1 (PL)
11	A1	C2	C4 (PL)	C3 (PL)	B1	C1	D2 (PL)	D1 (PL)
10	A1	C2	C4 (PL)	C3 (PL)	B1	C1	D2 (PL)	D1 (PL)
09	A1	C2	C4 (PL)	C3 (PL)	B1	C1	D2 (PL)	D1 (PL)
08	A1	C2	C4 (PL)	C3 (PL)	B1	C1	D2 (PL)	D1 (PL)
07	A1	C2	C4 (PL)	C3 (PL)	B1	C1	D2 (PL)	D1 (PL)
06	A1	C2	C4 (PL)	C3 (PL)	B1	C1	D2 (PL)	D1 (PL)
05	A1	C2	C4 (PL)	C3 (PL)	B1	C1	D2 (PL)	D1 (PL)
04	A1	C2	C4 (PL)	C3 (PL)	B1	C1	D2 (PL)	D1 (PL)
03	A1	C2	C4 (PL)	C3 (PL)	B1	C1	D2 (PL)	D1 (PL)
02	A1	C2	C4 (PL)	C3 (PL)	B1	C1	D2 (PL)	D1 (PL)
01	A1-G	C2-G	C4-G (PL)	C3-G (PL)	B1-G	C1-G	D2-G (PL)	D1-G (PL)

TYPE A1 1 BEDROOM 1 卧室	TYPE B1 2 BEDROOM 2 卧室	TYPE C1 3 BEDROOM 3 卧室	TYPE C2 3 BEDROOM 3 卧室
TYPE C3 (PL) 3 BEDROOM PREMIUM 豪华 3 卧室	TYPE C4 (PL) 3 BEDROOM PREMIUM 豪华 3 卧室	TYPE D1 (PL) 4 BEDROOM PREMIUM 豪华 4 卧室	TYPE D2 (PL) 4 BEDROOM PREMIUM 豪华 4 卧室

TYPE A1
 TYPE A1-R*
 45 SQM / 484 SQFT
 INCLUSIVE OF 4 SQM BALCONY & 2 SQM AC LEDGE
 #02-01 TO #24-01
 *#25-01

UNIT TYPE
1 BEDROOM

1 卧室

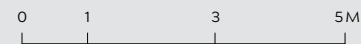
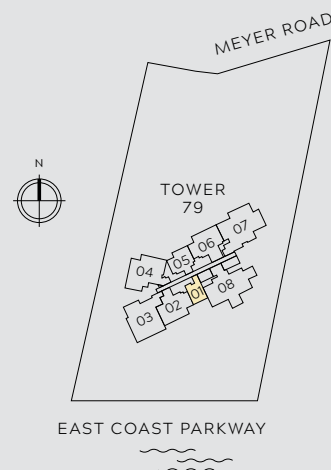

- | | | |
|-------------------------|----------------------------|------------------------------|
| F FRIDGE | WCH WINE CHILLER | DB DISTRIBUTION BOARD |
| D DRYER | GH GAS HOB | CO CONVECTIONAL OVEN |
| IH INDUCTION HOB | WM WASHER CUM DRYER | VD VACUUM DRAWER |
| SC SHOE CABINET | SO COMBI STEAM OVEN | W WASHER |

All plans are subject to amendments as may be approved by the relevant authorities.
 Floor areas are approximate measurements and are subjected to final survey.

TYPE B1
 64 SQM / 689 SQFT
 INCLUSIVE OF 6 SQM BALCONY & 3 SQM AC LEDGE
 #02-05 TO #24-05

UNIT TYPE
2 BEDROOM

2 卧室

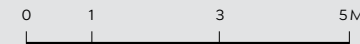
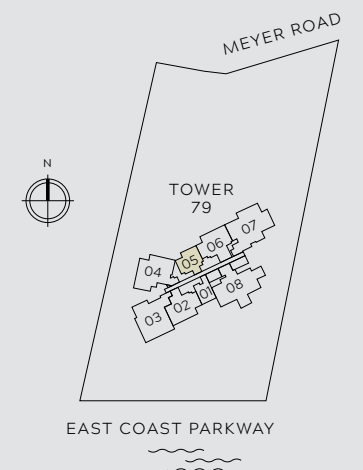

- | | | |
|-------------------------|----------------------------|------------------------------|
| F FRIDGE | WCH WINE CHILLER | DB DISTRIBUTION BOARD |
| D DRYER | GH GAS HOB | CO CONVECTIONAL OVEN |
| IH INDUCTION HOB | WM WASHER CUM DRYER | VD VACUUM DRAWER |
| SC SHOE CABINET | SO COMBI STEAM OVEN | W WASHER |

All plans are subject to amendments as may be approved by the relevant authorities.
 Floor areas are approximate measurements and are subjected to final survey.

TYPE B1-R
 82 SQM / 883 SQFT**
 INCLUSIVE OF 6 SQM BALCONY, 3 SQM AC LEDGE
 & 18 SQM STRATA VOID
 #25-05

TYPE C1
 103 SQM / 1109 SQFT
 INCLUSIVE OF 12 SQM BALCONY & 6 SQM AC LEDGE
 #02-06 TO #24-06

TYPE C1-R
 126 SQM / 1356 SQFT**
 INCLUSIVE OF 12 SQM BALCONY, 6 SQM AC LEDGE
 & 23 SQM STRATA VOID
 #25-06

UNIT TYPE
3 BEDROOM

3 卧室



**AREA IS INCLUSIVE OF STRATA VOID ABOVE LIVING AND DINING AS PER DOTTED LINE FOR TYPE C1-R

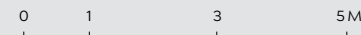

- | | | |
|-------------------------|----------------------------|------------------------------|
| F FRIDGE | WCH WINE CHILLER | DB DISTRIBUTION BOARD |
| D DRYER | GH GAS HOB | CO CONVECTIONAL OVEN |
| IH INDUCTION HOB | WM WASHER CUM DRYER | VD VACUUM DRAWER |
| SC SHOE CABINET | SO COMBI STEAM OVEN | W WASHER |

All plans are subject to amendments as may be approved by the relevant authorities.
 Floor areas are approximate measurements and are subjected to final survey.

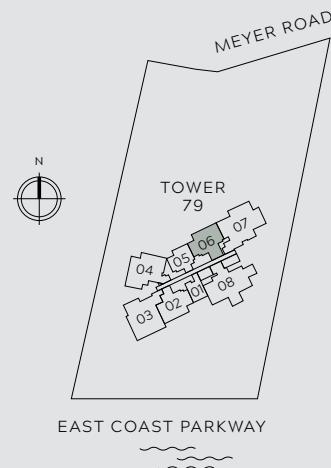

TYPE C2
 103 SQM / 1109 SQFT
 INCLUSIVE OF 12 SQM BALCONY & 6 SQM AC LEDGE
 #02-02 TO #24-02

TYPE C2-R
 129 SQM / 1389 SQFT**
 INCLUSIVE OF 12 SQM BALCONY, 6 SQM AC LEDGE
 & 26 SQM STRATA VOID
 #25-02

UNIT TYPE
3 BEDROOM

3 卧室



**AREA IS INCLUSIVE OF STRATA VOID ABOVE LIVING AND DINING AS PER DOTTED LINE FOR TYPE C2-R

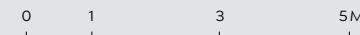

- | | | |
|-------------------------|----------------------------|------------------------------|
| F FRIDGE | WCH WINE CHILLER | DB DISTRIBUTION BOARD |
| D DRYER | GH GAS HOB | CO CONVECTIONAL OVEN |
| IH INDUCTION HOB | WM WASHER CUM DRYER | VD VACUUM DRAWER |
| SC SHOE CABINET | SO COMBI STEAM OVEN | W WASHER |

All plans are subject to amendments as may be approved by the relevant authorities.
 Floor areas are approximate measurements and are subjected to final survey.

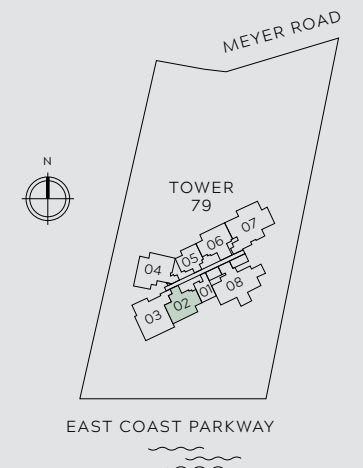



At Meyer Mansion, the balconies are deep and wide – reminiscent of the huge verandahs of old bungalows where you can enjoy breakfast looking out to the East Coast, or marvel as the sun sets over the city. Distinctive perforated screens act as a thin veil to provide shade and privacy whilst letting light in. And levelled flooring throughout gives you even larger living spaces, perfect for entertaining.

Within the apartment, only the finest materials, top-of-the-line appliances and luxurious fittings were selected to create the lifestyle of a luxe coastal resort.

美雅豪苑的宅邸都设有超大阳台，让人忆起旧式洋房宽敞的游廊，在这里您可一边享用早餐一边远眺东海岸迷人景致，或是欣赏城市落日，感叹自然之瑰丽。独特的多孔式屏风隐秘性与透光性俱佳。大平层设计为您营造出更开阔的居住空间，适合休闲娱乐。

公寓内部一律选用高档建材打造，装设顶级器具，配备奢华家具，旨在缔造尊贵而奢华的海岸度假生活方式。

TYPE C3 (PL)

130 SQM / 1399 SQFT

INCLUSIVE OF 15 SQM BALCONY & 7 SQM AC LEDGE

#02-04 TO #24-04

TYPE C3-R (PL)

160 SQM / 1722 SQFT**

INCLUSIVE OF 15 SQM BALCONY, 7 SQM AC LEDGE & 30 SQM STRATA VOID

#25-04

UNIT TYPE

3 BEDROOM PREMIUM

豪华 3 卧室



**AREA IS INCLUSIVE OF STRATA VOID ABOVE LIVING AND DINING AS PER DOTTED LINE FOR TYPE C3-R (PL)

TYPE C4 (PL)

139 SQM / 1496 SQFT

INCLUSIVE OF 10 SQM BALCONY & 8 SQM AC LEDGE

#02-03 TO #24-03

TYPE C4-R (PL)

170 SQM / 1830 SQFT**

INCLUSIVE OF 10 SQM BALCONY, 8 SQM AC LEDGE & 31 SQM STRATA VOID

#25-03

UNIT TYPE

3 BEDROOM PREMIUM

豪华 3 卧室



**AREA IS INCLUSIVE OF STRATA VOID ABOVE LIVING AND DINING AS PER DOTTED LINE FOR TYPE C4-R (PL)

0 1 3 5M

- | | | |
|------------------|---------------------|-----------------------|
| F FRIDGE | WCH WINE CHILLER | DB DISTRIBUTION BOARD |
| D DRYER | GH GAS HOB | CO CONVECTIONAL OVEN |
| IH INDUCTION HOB | WM WASHER CUM DRYER | VD VACUUM DRAWER |
| SC SHOE CABINET | SO COMBI STEAM OVEN | W WASHER |

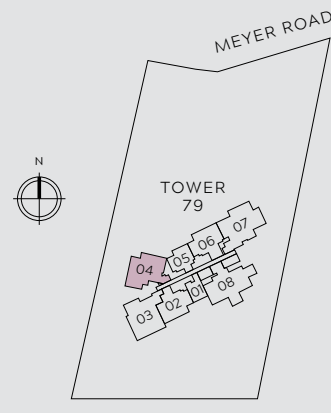

EAST COAST PARKWAY

All plans are subject to amendments as may be approved by the relevant authorities. Floor areas are approximate measurements and are subjected to final survey.

0 1 3 5M

- | | | |
|------------------|---------------------|-----------------------|
| F FRIDGE | WCH WINE CHILLER | DB DISTRIBUTION BOARD |
| D DRYER | GH GAS HOB | CO CONVECTIONAL OVEN |
| IH INDUCTION HOB | WM WASHER CUM DRYER | VD VACUUM DRAWER |
| SC SHOE CABINET | SO COMBI STEAM OVEN | W WASHER |

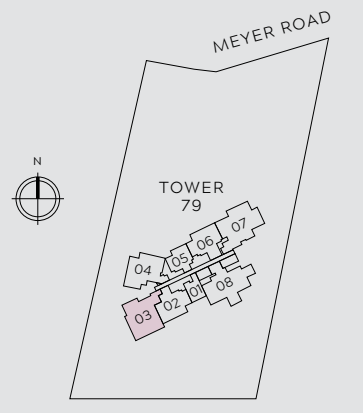

EAST COAST PARKWAY

All plans are subject to amendments as may be approved by the relevant authorities. Floor areas are approximate measurements and are subjected to final survey.

TYPE D1 (PL)

160 SQM / 1722 SQFT

INCLUSIVE OF 22 SQM BALCONY & 8 SQM AC LEDGE

#02-08 TO #24-08

TYPE D1-R (PL)

195 SQM / 2099 SQFT**

INCLUSIVE OF 22 SQM BALCONY, 8 SQM AC LEDGE
& 35 SQM STRATA VOID

#25-08

UNIT TYPE

4 BEDROOM PREMIUM

豪华 4 卧室

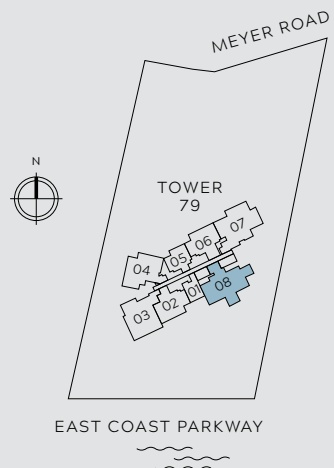

- | | | | | | |
|----|---------------|-----|------------------|----|--------------------|
| F | FRIDGE | WCH | WINE CHILLER | DB | DISTRIBUTION BOARD |
| D | DRYER | GH | GAS HOB | CO | CONVECTIONAL OVEN |
| IH | INDUCTION HOB | WM | WASHER CUM DRYER | VD | VACUUM DRAWER |
| SC | SHOE CABINET | SO | COMBI STEAM OVEN | W | WASHER |

All plans are subject to amendments as may be approved by the relevant authorities.
Floor areas are approximate measurements and are subjected to final survey.

TYPE D2 (PL)

164 SQM / 1765 SQFT

INCLUSIVE OF 20 SQM BALCONY & 8 SQM AC LEDGE

#02-07 TO #24-07

TYPE D2-R (PL)

199 SQM / 2142 SQFT**

INCLUSIVE OF 20 SQM BALCONY, 8 SQM AC LEDGE
& 35 SQM STRATA VOID

#25-07

UNIT TYPE

4 BEDROOM PREMIUM

豪华 4 卧室

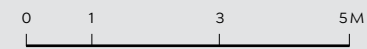
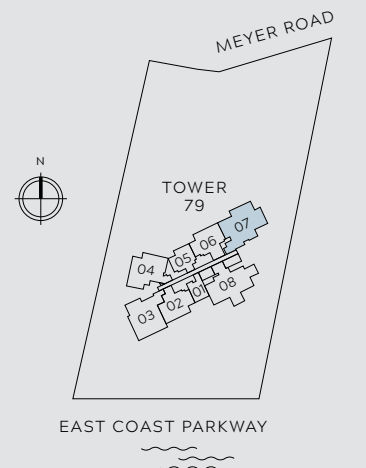

- | | | | | | |
|----|---------------|-----|------------------|----|--------------------|
| F | FRIDGE | WCH | WINE CHILLER | DB | DISTRIBUTION BOARD |
| D | DRYER | GH | GAS HOB | CO | CONVECTIONAL OVEN |
| IH | INDUCTION HOB | WM | WASHER CUM DRYER | VD | VACUUM DRAWER |
| SC | SHOE CABINET | SO | COMBI STEAM OVEN | W | WASHER |

All plans are subject to amendments as may be approved by the relevant authorities.
Floor areas are approximate measurements and are subjected to final survey.



GUOCO MIDTOWN
国浩时代城

ARTIST'S IMPRESSION 艺术效果图



GUOCO TOWER
国浩大厦



LEEDON RESIDENCE
丽敦苑



GOODWOOD RESIDENCE
优景苑



MARTIN MODERN
玛庭豪苑

ARTIST'S IMPRESSION 艺术效果图

PASSIONATELY CRAFTED

BY THE AWARD-WINNING TEAM

屡获殊荣的团队 震撼世界的力作

GuocoLand, since its listing on the Singapore Exchange in 1978, has been creating remarkable homes for the most discerning. Building on a track record of award-winning luxury developments including Martin Modern, Goodwood Residence, Leedon Residence and Wallich Residence in the prime locations of Orchard and River Valley, GuocoLand is now raising the bar of luxury living in the East with Meyer Mansion.

By sharing the same pedigree as all our other outstanding developments, homeowners can expect the finest quality, prestige and modern sophistication of Singapore's most sought-after Districts 9 and 10 at Meyer Mansion. Coupled with an exclusive address along the East Coast, Meyer Mansion stands out by offering luxuriously modern seaside-living that's set to cement its place in GuocoLand's stellar portfolio.

国浩房地产集团自1978年在新加坡交易所上市以来，一直致力于为精英人士打造堪称典范的顶级豪宅。国浩房地产集团备受赞赏的豪宅项目多不胜数，例如坐拥乌节路和里峇峇利路稀有地段的玛庭豪苑、优景苑、丽敦苑以及华利世家，而该集团的全新力作——美雅豪苑将树立新加坡东部奢华生活方式的新标杆。

正如国浩房地产集团的其他所有经典项目一样，美雅豪苑的居住者能够在新加坡最显贵的9区和10区尊享备受敬仰的高品质生活和极其完善的现代化设施。美雅豪苑选址东海岸的黄金地段，力求打造低调奢华的现代海滨生活方式，是国浩房地产集团众多杰出项目中的一颗璀璨明星。

豪华物业发展商
A LUXURY PROPERTY BY



MeyerMansion.com.sg

TO OWN YOUR FREEHOLD MANSION WITH A VIEW,
CALL 6225 9000
永久地契, 您的景观豪宅, 致电 6225 9000

ARCHITECT 建筑师
ADDP ARCHITECTS LLP

LANDSCAPE ARCHITECT 景观建筑师
COEN DESIGN INTERNATIONAL

INTERIOR DESIGN 室内设计
INDEX DESIGN

CREATIVE 创意机构
CATALYST

NAME OF HOUSING DEVELOPER: MEYER MANSION PTE. LTD. (CO. REG NO: 199407205R) · DEVELOPER'S LICENCE NO: C1337 · TENURE OF LAND: ESTATE IN FEE SIMPLE · LOCATION OF HOUSING PROJECT: LOT 04881V MK 25 AT MEYER ROAD · ENCUMBRANCE ON LAND: ENCUMBERED TO OVERSEA-CHINESE BANKING CORPORATION LIMITED (AS MORTGAGEE) PURSUANT TO MORTGAGE NO. IF/726911N · EXPECTED DATE OF VACANT POSSESSION: 31 DEC 2024 · EXPECTED DATE OF LEGAL COMPLETION: 31 DEC 2027

DISCLAIMER: THE INFORMATION AND CONTENTS HEREIN ARE CURRENT AT THE TIME OF PRINTING AND ARE PROVIDED ON AN "AS IS" AND "AS AVAILABLE" BASIS. WHILE ALL REASONABLE CARE HAS BEEN TAKEN IN PREPARING THIS BROCHURE, THE DEVELOPER AND ITS AGENTS SHALL NOT BE HELD RESPONSIBLE FOR ANY INACCURACIES OR THE COMPLETENESS OF THE INFORMATION AND CONTENT HEREIN. ALL RENDERINGS, ILLUSTRATIONS, PICTURES, PHOTOGRAPHS AND OTHER GRAPHIC REPRESENTATIVES AND REFERENCES ARE ARTIST'S IMPRESSIONS ONLY AND MAY BE SUBJECT TO CHANGES AND DEVIATION AS FURTHER MADE BY THE DEVELOPER OR AS REQUIRED BY THE RELEVANT AUTHORITIES. NOTHING HEREIN SHALL FORM PART OF AN OFFER OR CONTRACT OR BE CONSTRUED AS ANY REPRESENTATIONS BY THE DEVELOPER OR ITS AGENTS. THE PLANS DRAWN HEREIN MAY NOT BE TO SCALE, AND THE AREAS AND MEASUREMENTS STATED HEREIN ARE APPROXIMATE AND ARE SUBJECT TO ADJUSTMENTS ON FINAL SURVEY.

